

## KENTALROOF CONFORT 400 M4 0,55kW (27940480PAM)

### GENERAL DATA



#### ROOF FAN WITH HINGED SYSTEM AND ABS COWL

##### MANUFACTURING FEATURES:

- ABS protection cowl easily removable for access to motor and impeller thanks to the integrated folding system. The ABS cowl is characterized by its toughness, resistance to impacts and is able to withstand extreme ambient temperatures. 100% of the ABS used in the this cowl is recycled.
- The design of the cowl with a **rounded shape** is specific to minimize the risk of water ingress due to rain.
- Equipped with a **hinged system** to open the motor-impeller set. This system allows easy maintenance and cleaning of the set without the need to disassemble the entire structure. The opening is possible in 2 inclinations: approximately 45° and 90°, as required by the intervention.
- Structure in anticorrosive galvanized steel and support frame for adaptation to the roof with anti-bird protection grid.
- High-performance, backward-curved blade (reaction) impellers designed to work without scroll. Self-cleaning system, built in galvanized steel treated with anti-corrosion.
- Standard asynchronous squirrel cage motor with IP-55 protection and Class F insulation. Standard voltages 230V 50Hz for single phase motors, 230/400V 50Hz for three phase motors up to 4kW & 400/690V 50Hz for higher powers and 400V 50Hz for 2 speed motors.

#### APPLICATIONS

Designed for deck or roof mounting, they are indicated for:

- Smoke extraction.
- Air renewal in all types of buildings and industries.
- Maximum continuous working temperature: transported air 80°C, ambient 60°C to -25°C in three-phase motors.

#### UNDER REQUEST

- Special voltages.

PERFORMANCE CURVE

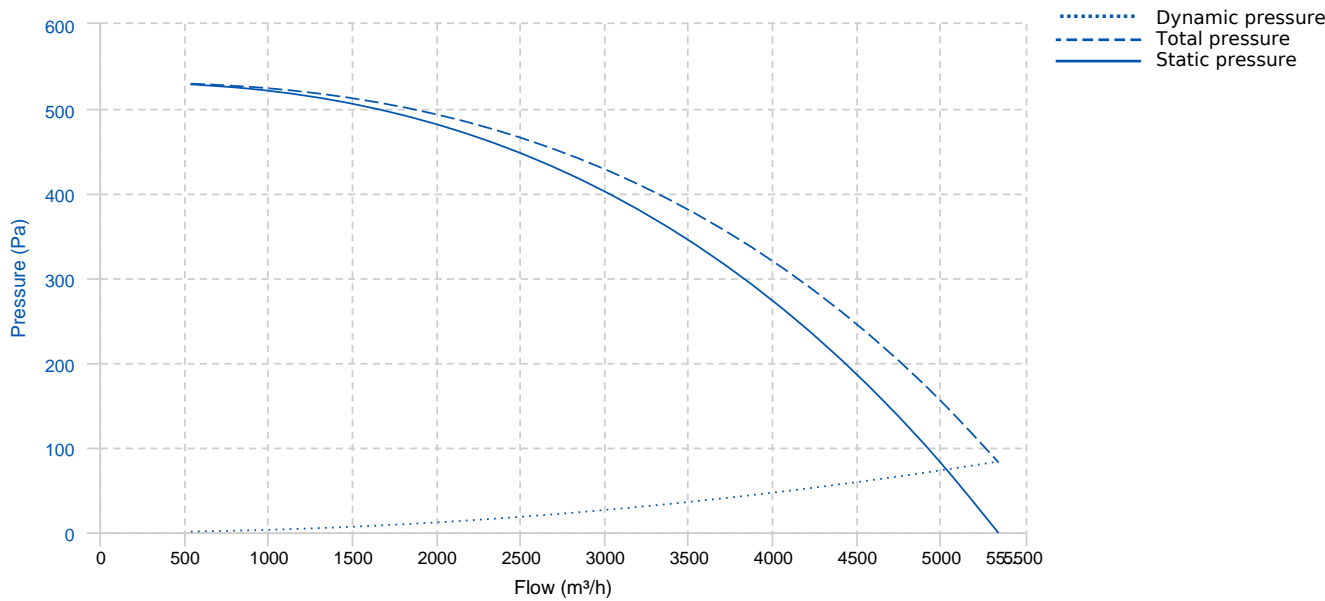

TECHNICAL DATA

Fan							
RPM	1400	Approx. weight	45 kg	Max. Flow	5340 m³/h		
Motor							
Power	0,55 kW	RPM	1400	Capacitor	20µF 450V	I max. (230V)	3,98 A
Size	80	Approx. weight	9.1 kg	Efficiency (%)	64 %	FP	0.95

DIMENSIONS

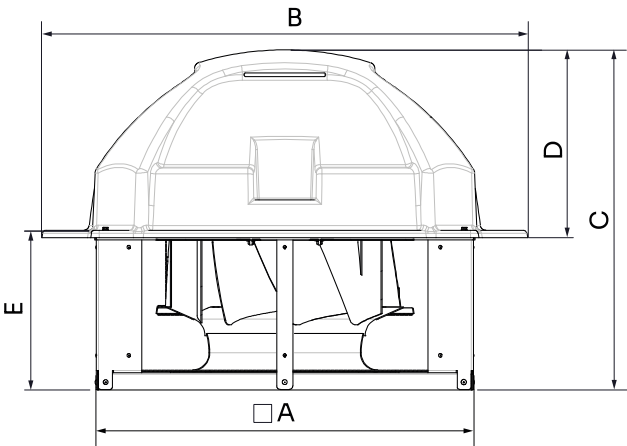

Dimensions (mm)									
A (int)	662	B	865.3	C	647.5	D	365	E	295.5

## WIRING DIAGRAM

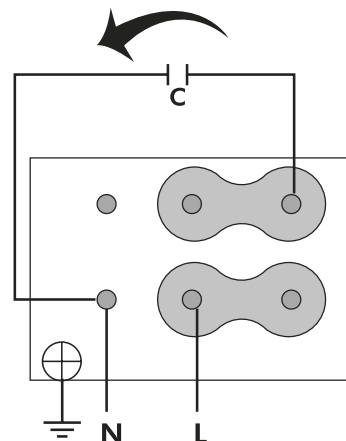
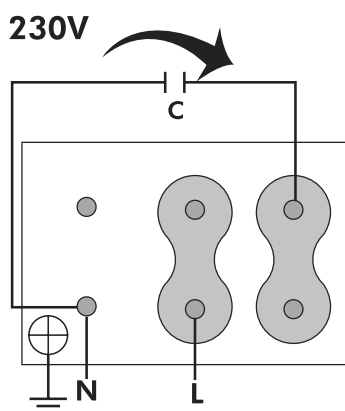

## ACCESSORIES



**SAFETY SWITCH**  
**INT 25 3P A**  
**REF: INT253PA**



**CONNECTION FLANGE**  
**AC 400**  
**REF: 960003212**



**CIRCULAR SILENCER**  
**SIL-C 400/400**  
**REF: 960040040**



**CIRCULAR SILENCER**  
**SIL-C 400/600**  
**REF: 960040060**

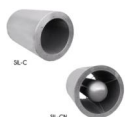

**CIRCULAR SILENCER**  
**SIL-C 400/800**  
**REF: 960040080**



**CIRCULAR SILENCER**  
**SIL-CN 400/400**  
**REF: 961040040**



**CIRCULAR SILENCER**  
**SIL-CN 400/600**  
**REF: 961040060**

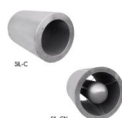

**CIRCULAR SILENCER**  
**SIL-CN 400/800**  
**REF: 961040080**



**CIRCULAR-CIRCULAR ANTI-VIBRATION FLANGE**  
**BAD 11 (Ø400)**  
**REF: 960003461**

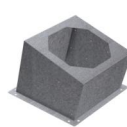

**INCLINED ROOF FAN SUPPORT**  
**BTI 640**  
**REF: A-50870640XX**

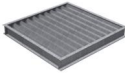

**DEPRESSION DAMPER  
(HORIZONTAL or  
VERTICAL PLACEMENT)  
CMP-HUT 500x510  
REF: CMPHUT5051**



**KENTALROOF VERTICAL DISCHARGE  
KV KENTALROOF 400  
REF: KVKNTR400**

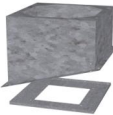

**BTI + ACMP MOUNTED  
BTI+ACMP 640  
REF: BTIACMP640XX**

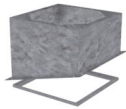

**BTI + AMC MOUNTED  
BTI+AMC 640  
REF: BTIAMC640XX**

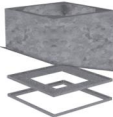

**BTI + ACMP+AMC MOUNTED  
BTI+ACMP+AMC 640  
REF: BTIACMPAMC640XX**